

INSTRUCTIONS FOR COLLECTION

RHINOstic® Automated Swab

STEP 1 Removal



1. Carefully remove the swab portion for sample collection from the polybag without touching the collection end of the swab.
2. Remove the transport tube from the package so that after collection it is ready for the sample to be placed into the transport tube.

STEP 2 Collect Sample

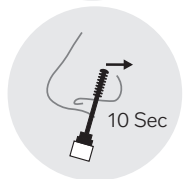
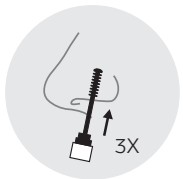
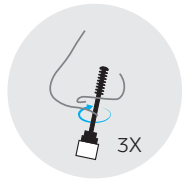

3. Hold the swab portion of the collection device by the cap and collect the sample as follows:
 - a. Insert the tip of the swab into one (1) nostril until pressure is felt in the nose. The swab should be placed just inside your nostril.
 - b. Rotate the swab around the inside of the nostril three (3) times being sure you are making firm contact with the inside of your nose.
 - c. Gently slide the swab up and down against the inside of the nose one time.
 - d. Firmly hold the swab against the inside of the nostril for ten (10) seconds.

STEP 3 Repeat

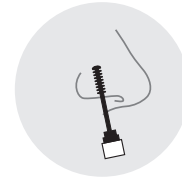

4. Repeat collection steps (a-d) in the second nostril using the same swab.

STEP 4 Seal

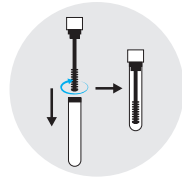

6. Carefully screw the swab into the tube, so that it is completely closed. Make sure the tube is closed tightly. The original tube cap is no longer needed and should be thrown away.

INSTRUCTIONS FOR COLLECTION

RHINOstic® Automated Swab

STEP 1 Removal

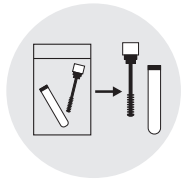

1. Carefully remove the swab portion for sample collection from the polybag without touching the collection end of the swab.
2. Remove the transport tube from the package so that after collection it is ready for the sample to be placed into the transport tube.

STEP 2 Collect Sample

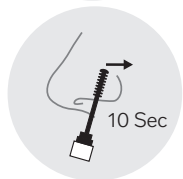
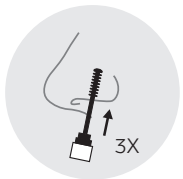
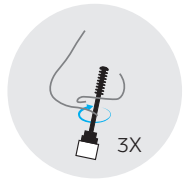

3. Hold the swab portion of the collection device by the cap and collect the sample as follows:
 - a. Insert the tip of the swab into one (1) nostril until pressure is felt in the nose. The swab should be placed just inside your nostril.
 - b. Rotate the swab around the inside of the nostril three (3) times being sure you are making firm contact with the inside of your nose.
 - c. Gently slide the swab up and down against the inside of the nose one time.
 - d. Firmly hold the swab against the inside of the nostril for ten (10) seconds.

STEP 3 Repeat

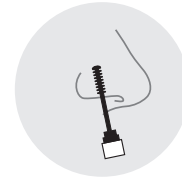

4. Repeat collection steps (a-d) in the second nostril using the same swab.

STEP 4 Seal

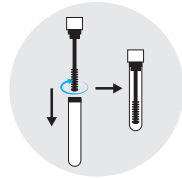

5. Carefully screw the swab into the tube, so that it is completely closed. Make sure the tube is closed tightly.