

INSTRUCTIONS FOR COLLECTION

RHINOstic® Automated Swab

STEP 1
Removal

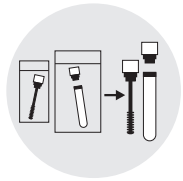

1. Carefully remove the swab portion for sample collection from the polybag without touching the collection end of the swab.
2. Remove the transport tube from the package so that after collection it is ready for the sample to be placed into the transport tube.

STEP 2
Collect Sample



3. Hold the swab portion of the collection device by the cap and collect the sample as follows:
 - a. Insert the tip of the swab into the vaginal canal.
 - b. Gently twirl in vaginal canal for 60 seconds.

STEP 3
Seal

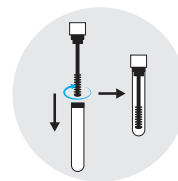

4. Remove the cap from the tube and discard. Replace the cap with the swab in the tube portion of the collection device.
5. Carefully screw the swab into the tube, so that it is completely closed. Make sure the tube is closed tightly. The original tube cap is no longer needed and should be thrown away.

INSTRUCTIONS FOR COLLECTION

RHINOstic® Automated Swab

STEP 1
Removal



1. Carefully remove the swab portion for sample collection from the polybag without touching the collection end of the swab.
2. Remove the transport tube from the package so that after collection it is ready for the sample to be placed into the transport tube.

STEP 2
Collect Sample



3. Hold the swab portion of the collection device by the cap and collect the sample as follows:
 - a. Insert the tip of the swab into the vaginal canal.
 - b. Gently twirl in vaginal canal for 60 seconds.

STEP 3
Seal

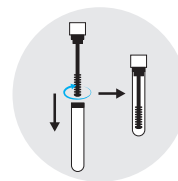

4. Remove the cap from the tube and discard. Replace the cap with the swab in the tube portion of the collection device.
5. Carefully screw the swab into the tube, so that it is completely closed. Make sure the tube is closed tightly. The original tube cap is no longer needed and should be thrown away.
6. If two swabs are included in your kit, repeat steps 1-5 for the second one.

INSTRUCTIONS FOR USE

RHINOstic® Automated Swab

STEP 1
Removal

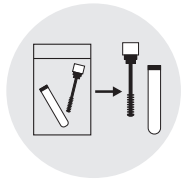

1. Carefully remove the swab portion for sample collection from the polybag without touching the collection end of the swab.
2. Remove the transport tube from the package so that after collection it is ready for the sample to be placed into the transport tube.

STEP 2
Collect Sample

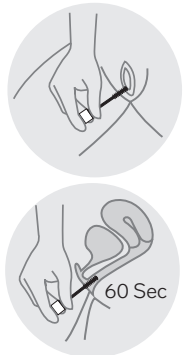

3. Hold the swab portion of the collection device by the cap and collect the sample as follows:
 - a. Insert the tip of the swab into the vaginal canal.
 - b. Gently twirl in vaginal canal for 60 seconds.

STEP 3
Seal

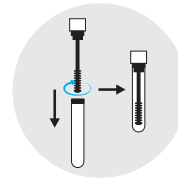

4. Place the cap with the swab in the tube portion of the collection device.
5. Carefully screw the swab into the tube, so that it is completely closed. Make sure the tube is closed tightly.