

INSTRUCTIONS FOR COLLECTION

Rhinostics Standard Swab

STEP 1 Collect Sample

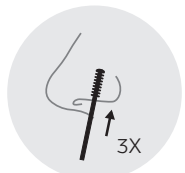
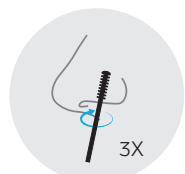

1. Carefully remove the swab portion for sample collection from the package without touching the collection end of the swab.
2. Hold the collection portion of the swab on the shaft and collect the sample as follows:
 - a. Insert the tip of the swab into one (1) nostril until pressure is felt in the nose. The swab should be placed just inside your nostril.
 - b. Rotate the swab around the inside of the nostril three (3) times being sure you are making firm contact with the inside of your nose.
 - c. Gently slide the swab up and down against the inside of the nose one time.
 - d. Firmly hold the swab against the inside of the nostril for ten (10) seconds.

STEP 2 Repeat



3. Repeat collection steps (a-d) in the second nostril using the same swab.

STEP 3 Seal

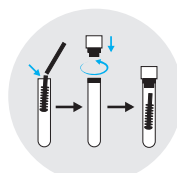
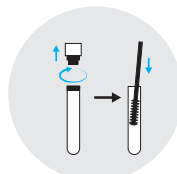

4. Remove the cap from the tube but keep the cap safe for recapping. Place collection end of the swab in the tube. Bend the swab so that the tip snaps off, leaving the swab in the collection tube. Discard the shaft of the swab.
5. Replace the cap into the collection device. Make sure the cap is completely closed to ensure that the swab does not come out.